

Save This User Manual for Future Reference

To sell in Canada only

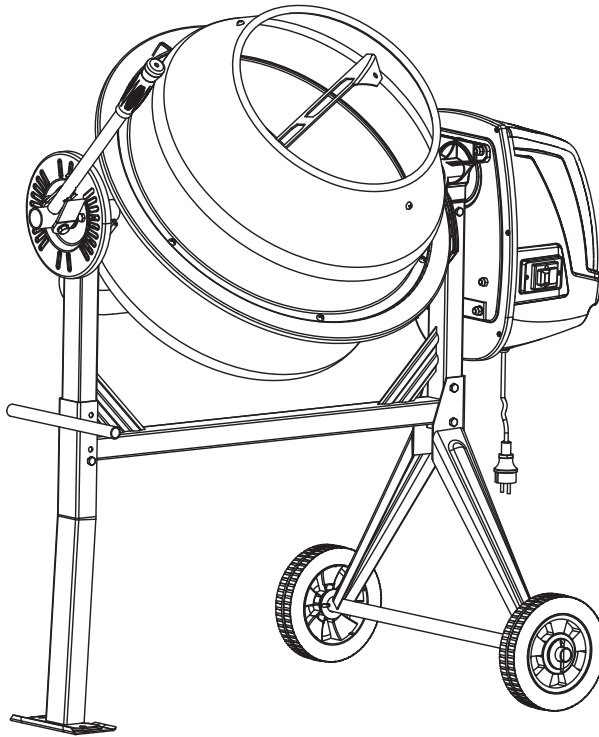

Electric Concrete Mixer

User Manual

Model No.: DUECM-115-E

WARNING! Read and understand all instructions before using this cement mixer.



120 V

SAVE THIS MANUAL

Keep this manual and the original sales invoice in a safe, dry place for future reference.

SAFETY WARNINGS AND INSTRUCTIONS

SYMBOL AFFIXED TO THE MACHINE

● UNDERSTAND YOUR MIXER

Read and understand the User Manual and labels affixed to the mixer. Learn its application and limitations, as well as the specific potential hazards peculiar to it.

Become familiar with the controls before operating this mixer.

● STAY ALERT

Do not operate the mixer while under the influence of drugs, alcohol, or any medication that could affect your ability to use it properly.

Do not use this mixer when you are tired or distracted from the job at hand. Watch what you are doing at all times. Use common sense.

● AVOID DANGEROUS CONDITIONS

Make sure there is sufficient surrounding workspace.

Keep your work area clean and well lighted. Cluttered areas invite injuries. Keep the area around the mixer clear of obstructions, grease, oil, trash and other debris which could cause people to fall onto moving parts.

Only use or operate the mixer on solid, flat, level ground that is capable of supporting the weight of the mixer and its load, to prevent the mixer from tipping over.

Do not attempt to move the mixer when it is loaded and/or in operation.

This mixer is intended for the production of concrete, mortar and plaster. It is not suitable for the mixing of flammable or explosive substances. Do not use it in areas where fumes from paint, solvents or flammable liquids pose a potential hazard.

● INSPECT YOUR MIXER

Check your mixer before turning it on. Keep guards in place and in working order. Do not plug mixer with motor cover off.

Check all bolts, nuts, and screws for tightness before each use, especially those securing guards and drive mechanisms.

Vibration during mixing may cause these to loosen.

Form a habit of checking to see that all the adjusting tools, shovels, hand trowels and other tools/equipments are removed from the mixer area before turning it on.

Replace damaged, missing or failed parts before using it.

Warning labels carry important information. Replace any missing or damaged warning labels.

● DRESS PROPERLY

Do not wear loose clothing, gloves, neckties or jewelry (rings, wrist watches). They can be caught in moving parts. Protective electrically non-conductive gloves and non-skid footwear are recommended when working. Wear protective hair covering to contain long hair, preventing it from getting caught in machinery. Wear a face or dust mask if the operation is dusty. Always wear safety goggles and/or face shields. Everyday eyeglasses have only impact resistant lenses. They are not safety glasses.



● DO NOT ABUSE CORD

Never carry mixer by cord or yank it to disconnect it from the socket.

Keep cord from heat, oil and sharp edges.

● EXTENSION CORDS

Use only 3-wire extension cords that have 3-prong grounding plugs and 3-pole receptacles that accept the tool's plug. Verify that the extension cord is no longer than 32.5 feet (10 m) and that its cross-section is no less than 1/8 inch (2.5 mm), in order to allow sufficient current to flow to the motor. Improper use of extension cords may cause inefficient operation of the mixer which can result in overheating and motor damage.

Avoid use of free and inadequately insulated connections. Connections must be made with protected material suitable for outdoor use. Make sure that any extension cord connections are dry and safe. Ensure that the extension cord is carefully laid out avoiding liquids, sharp edges and places where vehicles might run over it. Avoid allowing the extension cord to be trapped underneath the mixer. Unroll it fully or it will overheat and could catch fire.

● AVOID ELECTRICAL SHOCK

Check that the electric circuit is adequately protected and that it corresponds with the power, voltage and frequency of the motor. Do not plug or unplug the motor while standing in or around damp or wet ground. Do not use the mixer in wet or damp areas or expose it to rain.

Prevent body contact with grounded surfaces: pipes, radiators, ranges, and refrigerator enclosures.

Make sure your fingers do not touch the plug's metal prongs when plugging or unplugging the mixer.

● GROUNDING INSTRUCTIONS

In the event of a malfunction or breakdown, grounding provides a path of least resistance for electric current to reduce the risk of electric shock. This tool is equipped with an electric cord having an equipment-grounding conductor and a grounding plug. The plug must be plugged into a matching outlet that is properly installed and grounded in accordance with all local codes and ordinances.

Do not modify the plug provided – if it will not fit the outlet, have the proper outlet installed by a qualified electrician.

Improper connection of the equipment-grounding conductor can result in a risk of electric shock. The conductor with insulation having an outer surface that is green with or without yellow stripes is the equipment-grounding conductor. If repair or replacement of the electric cord or plug is necessary, do not connect the equipment-grounding conductor to a live terminal.

Check with a qualified electrician or service personnel if the grounding instructions are not completely understood, or if in doubt as to whether the tool is properly grounded.

Repair or replace a damaged or worn cord immediately.

SAFETY WARNINGS AND INSTRUCTIONS

SYMBOL AFFIXED TO THE MACHINE

● KEEP VISITORS AND CHILDREN AWAY

Keep unauthorized people away from the mixer.
Do not allow children to handle or climb on or in the mixer.

● DO NOT OVERREACH

Keep proper footing and balance at all times when loading or unloading the mixer.
Never stand on the mixer. Serious injury could occur if the mixer is tipped or if the moving parts are unintentionally contacted.
Do not store anything above or near the mixer where someone might stand on the mixer to reach it.

● AVOID ACCIDENTS

Keep hands out of the way of all moving parts. Do not place any part of your body or any tool, like a shovel, in the drum during its operation. When operating, do not pass hands through the clearance between the frame and the support arm, or the clearance between the drum and the support arm.

● DO NOT FORCE THE MIXER

It will do a better and safer job at its design rate. Always work within the rated capacity.
Do not start the motor if the drum is fully loaded. Do not turn the mixer off while it is full of concrete.
Do not use the mixer for a purpose for which it was not intended. The mixer is not to be towed by any vehicle.

● NEVER LEAVE THE MIXER RUNNING UNATTENDED

Keep close supervision until it has come to a complete stop.

● DISCONNECT THE POWER

Never open the motor cover before unplugging the mixer. Disconnect from the power supply when not in use, before moving it, making adjustments, changing parts, cleaning it, or working on the mixer. Consult the technical manual before servicing.

● MAINTENANCE

Clean the mixer immediately after use. Keep the mixer clean for a better and safer performance.
When maintaining this mixer, only original replacement parts made by the same manufacturer should be used.

● ENVIRONMENT

Take left over materials to an authorized collection point or follow the stipulations in the country where the mixer is used. Do not discharge into drains, soil or water.

● STORAGE

When not in use, the mixer should be stored in a dry location to inhibit rust. Keep the mixer away from children and people not qualified to use it.



TABLE OF CONTENTS

Safety Warnings and Instructions	2
Specifications.....	5
Contents	6
Assembly Instructions	7
Operation Instructions	11
Maintenance Instructions	12
Wiring Diagram	12
Parts Schematic	13

SPECIFICATIONS

Model Number		DUECM-115-E
Motor		120 V, 60 Hz, 5 A
Drum Capacity		115 Liters (4 cuft)
Drum Mouth		385 mm
Drum Speed		26.7 / min
Overall Sizes	L	1200 mm
	W	710 mm
	H	1350 mm
Weight		41 kg

CONTENTS

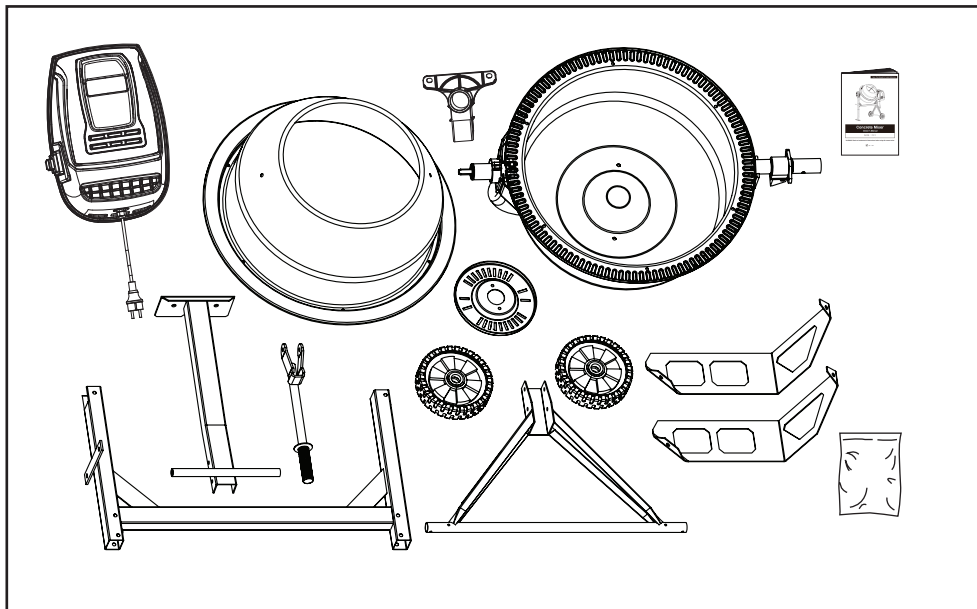

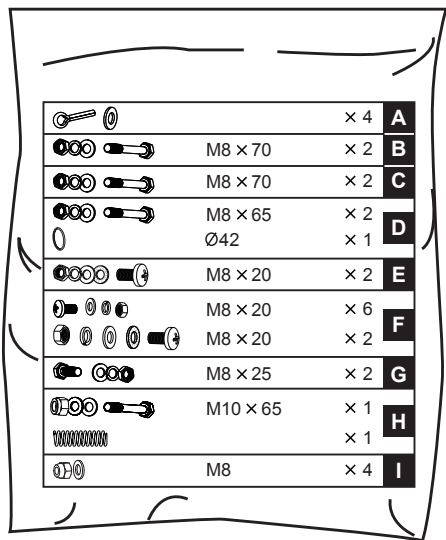

ASSEMBLY INSTRUCTIONS



It is recommended that two people assemble this product.

THE STAND

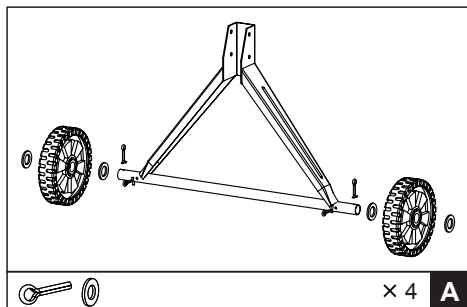

1. Insert a split pin into the holes on the axle bracket, and then place a flat washer, then a wheel followed by another flat washer. Insert another split pin into the axle bracket holes after the last washer. Bend each side of the pins outward so they do not fall off.

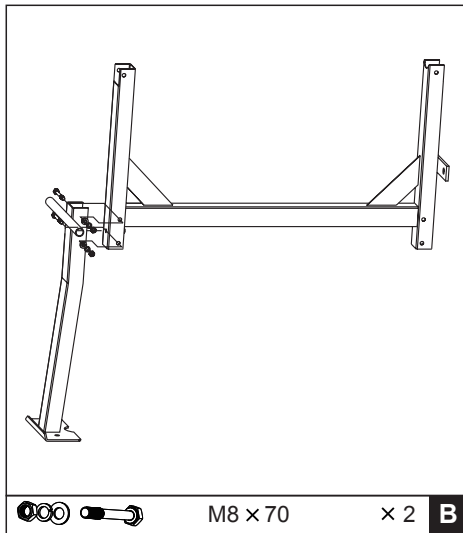

2. Attach the support leg to the frame as shown. Insert two M8 x 70 hexagonal bolts through the holes on one side, securing with flat washers, lock washers, and nuts on the other side.

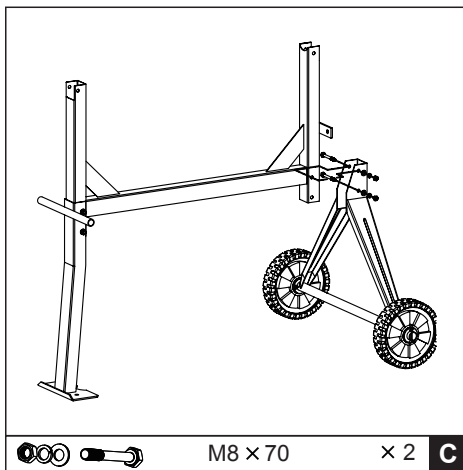

3. Attach the axle bracket with the wheels to the frame. Insert two M8 x 70 hexagonal bolts through the holes on one side, securing with flat washers, lock washers, and nuts on the other side. Make sure all bolts and nuts are tightened.

THE BOTTOM DRUM

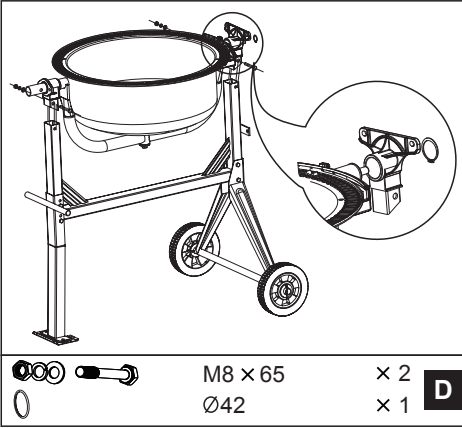

1. Slide the bearing block on the shaft. Hold it in place with an Ø42 spiral ring.
2. Carefully, and with two people, set the lower drum with the support arm onto the side supports of the stand as shown, so that the bearing block's slots fit into the channels provided by the side supports. The larger diameter shaft should be at the leg end of the stand.
3. At each side, line up the holes in the side support with those in the bearing block and insert a M8 X 65 hexagonal bolt from one side, then a flat washer, lock washer and nut from the other side. Tighten with a wrench.

THE MIXING BLADES

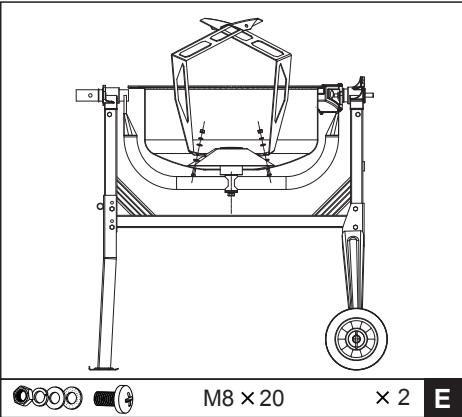

Mount the mixing blades inside the bottom drum loosely, as shown above. Two holes are provided at the base of the drum, into which two M8 x 20 bolts must be inserted from the outside. A leather washer, a flat washer, a lock washer, and a nut should be threaded on the inside loosely. The leather washer should be placed under the blade, against the drum.

NOTE: Two arrows are labelled on the upper drum and the bottom drum to make their position relation. If you have any difficulty in correctly positioning the mixing blades, it is helpful if you temporarily mount the upper drum on the top of the bottom drum, rotating it so that the two arrows line up.

THE UPPER DRUM

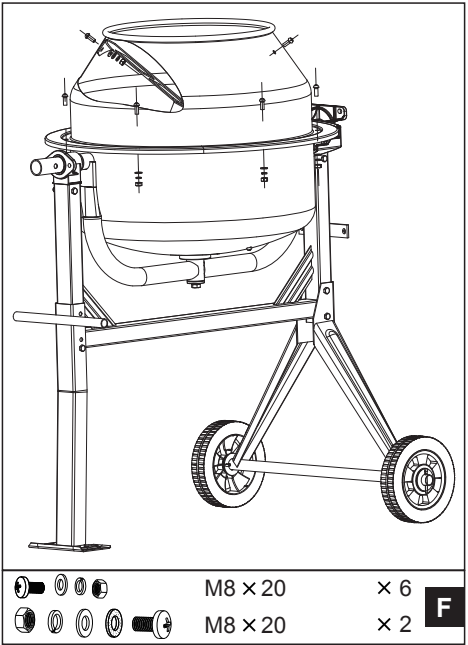

1. Position the upper drum on the lower drum over the rim, making sure the mounting holes align in both, as well as the labelled arrows.

2. Insert a M8 X 20 cross headed screw into each mounting hole in the rim. Secure each bolt from below with a flat washer, lock washer and nut. Make sure the tightening process is carried out progressively.
3. Secure the mixing blades to the upper drum by inserting two M8 X 20 cross headed screws, from the outside through the holes in the drum.
4. A leather washer should be positioned inside between the drum and the blade. Secure the mixing blade on the inside using a flat washer, spring washer and nut.
5. Finally, ensure the top and bottom mixing blade mountings are tight.

THE TIPPING BAR

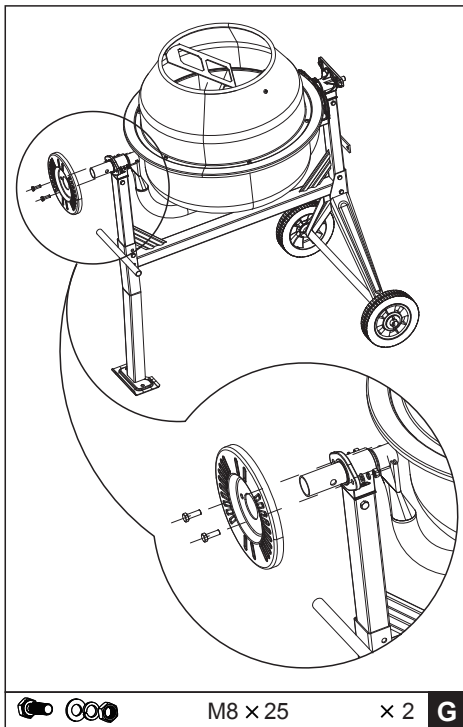

1. Slide the locking plate over the large diameter shaft at the leg end of the frame with the rim facing inwards as shown. Secure with two M8 X 25 bolts, each with a nut, lock and flat washers.

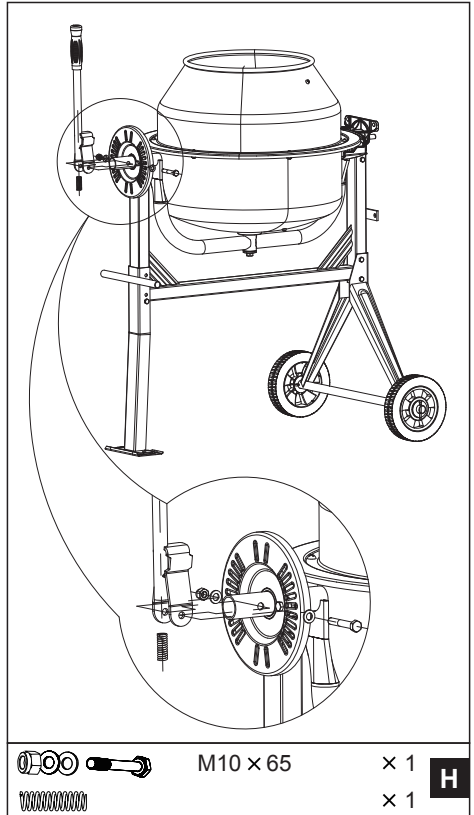

2. Insert the spring into the bar pipe. Holding it in place with a finger, place the bar over the larger diameter shaft so that the shaft retains the spring. Press down on the bar until the holes in the bracket line up with the hole drilled. Insert a M10 X 65 hexagonal bolt and screw on a nut with flat washers from the other side. Screw the nut up against the bracket firmly, but not so tightly so as to prevent the bar from pivoting about the bolt.

NOTE: *The tipping bar must be free to pivot around the bolt, so that the lugs on the bracket can be engaged or disengaged from the slots in the locking plate.*

MOTOR ASSEMBLY

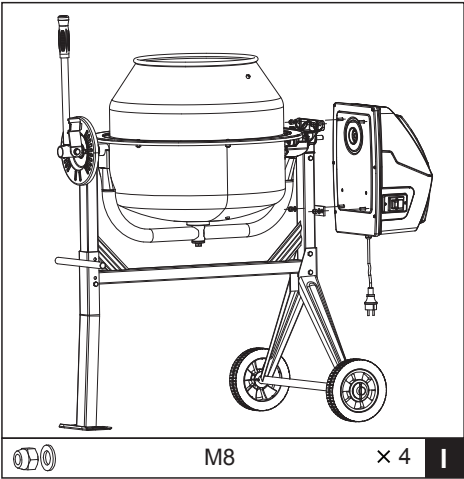

Lining up the keyways, slide the transmission case over the pinion shaft. Secure the case to the frame with four M8 lock nuts and flat washers.

OPERATION INSTRUCTIONS

DRUM TILTING

The spring-loaded tipping bar with locking lug provides an easy positive control of the drum, which can be locked in the mix, discharge, or storage position. The drum is locked in position by the lugs on the self-locating tipping bar, which engages into the locking plate on the mixer frame. To tilt the drum, withdraw the tipping bar to disengage the locking lug. This allows the tipping bar and the drum to be turned in the same direction. To hold the drum in position, align the lug with the hole and release the tipping bar a little while holding the drum. Rotate the tipping bar until the locking lug engages into the locking plate on the mixer frame.

Loading/Mixing Position

For Mortar

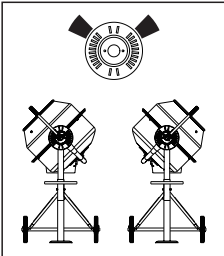

For Concrete

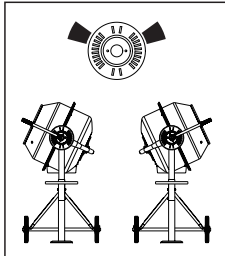

Emptying Position

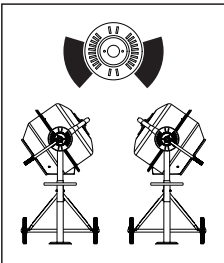

Storage Position

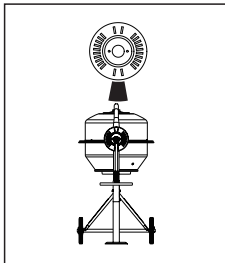

LOADING



Completely unwind the extension cord. Connect it to the mixer before plugging it into the power supply.



Always start the mixer before loading the drum. Load the drum only after it starts rotating.



Do not throw the material into the mixer carelessly. Trickle it steadily over the rim, so as to prevent it from sticking firmly to the back of the drum.

NOTE: A built-in circuit breaker is integrated with the motor to prevent it from overheating. If tripped, the circuit breaker will be automatically restored once the motor cools. Wait for approximately 10 minutes until it is restored before starting the motor again.

For best results, proceed as follows:

1. Add the required amount of gravel into the drum.
2. Add the required amount of cement into the drum.
3. Add the required amount of sand into the drum.
4. Pour the required amount of water into the drum.

EMPTYING



Do not turn the mixer off while it is loaded. Always empty the drum while the drum is rotating.

CLEANING



Never put hands inside the drum with the drum rotating.

Thoroughly clean the mixer at the end of each project. Never allow material to harden inside the drum. Keep your mixer clean. The slightest trace of material left in the drum will harden and attract more each time you use it, until the machine is useless. Dried cement should be scraped out of the drum. Do not throw bricks into mixer drum to clean it out. Do not beat on the drum with a shovel, a hammer, or other tools to break up accumulations of dried cement mix, as damage to the mixer may result. To clean fresh, stubborn accumulations, the drum may be scoured for approximately 2 minutes, using a 1 inch gravel and water mixture. Then, discharge the gravel/water mixture and hose down the drum assembly inside and out. The protection class construction of the concrete mixer enables you to hose down the drum assembly safely.



Do not pour or spray water directly over the motor cover, especially the openings in it.



Wipe off any external debris on the motor cover. Do not use gasoline, turpentine, lacquer, paint thinner, dry cleaning fluids, or similar products. The use of chemical products or solvents may affect the properties of the cover, which is made of high-density polyethylene / PET.

MAINTENANCE INSTRUCTIONS



Ensure the extension cord is unplugged before removing the motor cover.

The drive belt is kept under constant, even tension by a spring loaded jockey. No adjustment is required apart from a touch of grease on the spindle.

The bearings are permanently sealed.



The wiring diagram and parts schematic in this manual are only for your reference. Neither the manufacturer nor the distributor makes a warranty of any kind to the buyer that he or she is qualified to make any repairs to the product or that he or she is qualified to replace any parts of the product nor authorizes the buyer to do so.



Only qualified technicians should repair the mixer. Any maintenance and repairs carried out on any of the electric components must be undertaken by a qualified electrician.

WIRING DIAGRAM

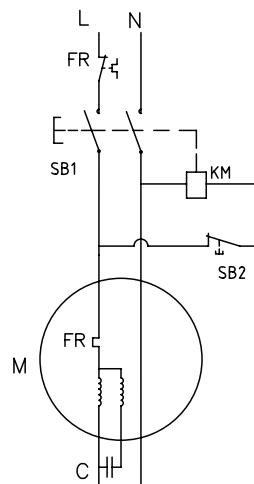

PARTS SCHEMATIC

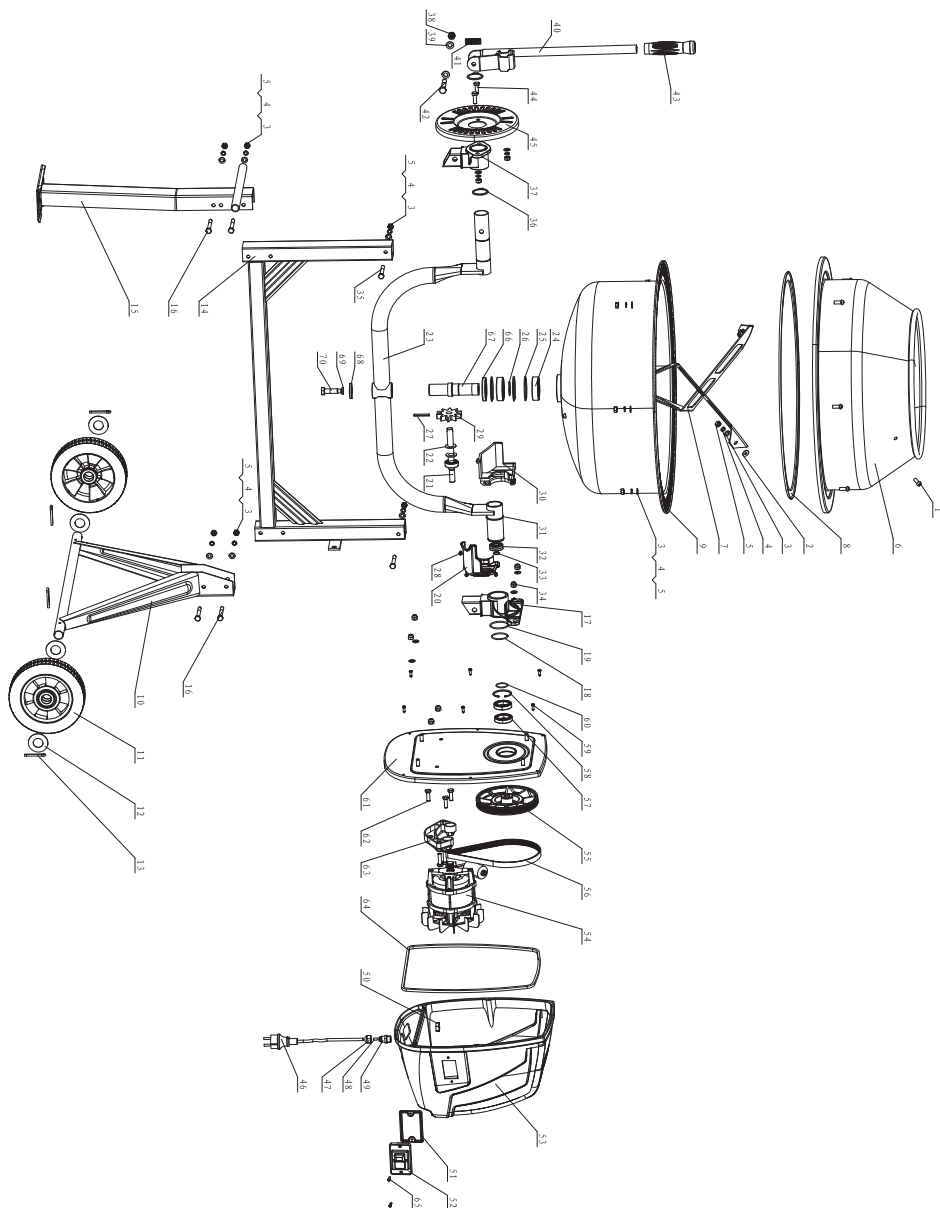

PARTS LIST

No.	Description	Qty
1	Cross Headed Screw M8 X 20	10
2	Leather Washer	4
3	Flat Washer 8	22
4	Spring Washer 8	18
5	Nut M8	18
6	Upper Drum	1
7	Mixing Blade	2
8	Rubber Gasket	1
9	Lower Drum	1
10	Axle Bracket	1
11	Wheel	2
12	Flat Washer 27	4
13	Cotter Pin 5 X 40	4
14	Frame	1
15	Support Leg	1
16	Bolt M8 X 70	4
17	Bearing Block - Right	1
18	Circlip 42	1
19	O-ring	1
20	Gear Guard - Long	1
21	Drive Shaft	1
22	Sleeve Pipe	2
23	Cradle	1
24	Bearing 6206	2
25	Circlip 62	3
26	Circlip 30	1
27	Lock Pin 5 X 40	1
28	Sheet Metal Screw St4.2 X 13	3
29	Drive Pinion	1
30	Gear Guard - Short	1
31	Circlip 42	1
32	Bearing 6202	2
33	Circlip 15	1
34	Lock Nut M8	4
35	Bolt M8 X 65	2
36	Circlip 38	2
37	Bearing Block - Left	1
38	Lock Nut M10	1

No.	Description	Qty
39	Flat Washer 10	2
40	Tipping Bar	1
41	Spring	1
42	Bolt M10 X 65	1
43	Handle Grip	1
44	Bolt M8 X 25	5
45	Locking Plate	1
46	Power Cord	1
47	Strain Relief Nut	1
48	Strain Relief Rubber	1
49	Strain Relief Bolt	1
50	Strain Relief Nut	1
51	Gasket, Switch	1
52	Switch	1
53	Motor Cover	1
54	Motor	1
55	Idle Pulley	1
56	Belt	1
57	Bearing 6906	2
58	Snap Washer – Hole 47	1
59	Sheet Metal Screw St4.2 X 16	6
60	Circlip 30	1
61	End Plate	1
62	Bolt M8 X 30	2
63	Motor Mount Bracket, End Plate	1
64	Gasket	1
64	Self Tapping Screw ST3.5 X 16	1
66	Oil Seal 62 X 35 X 8	1
67	Fixed Shaft	1
68	Washer	1
69	Spring Washer 12	1
70	Bolt M12 x 35	1