

POWERED BY

# DUCAR

PROPULSÉ PAR

## Equipment parts manual

**Model : DUEDCS-RR48**  
**48" floor ripper for DCS**



Picture may not reflect the exact model

# RIPPER

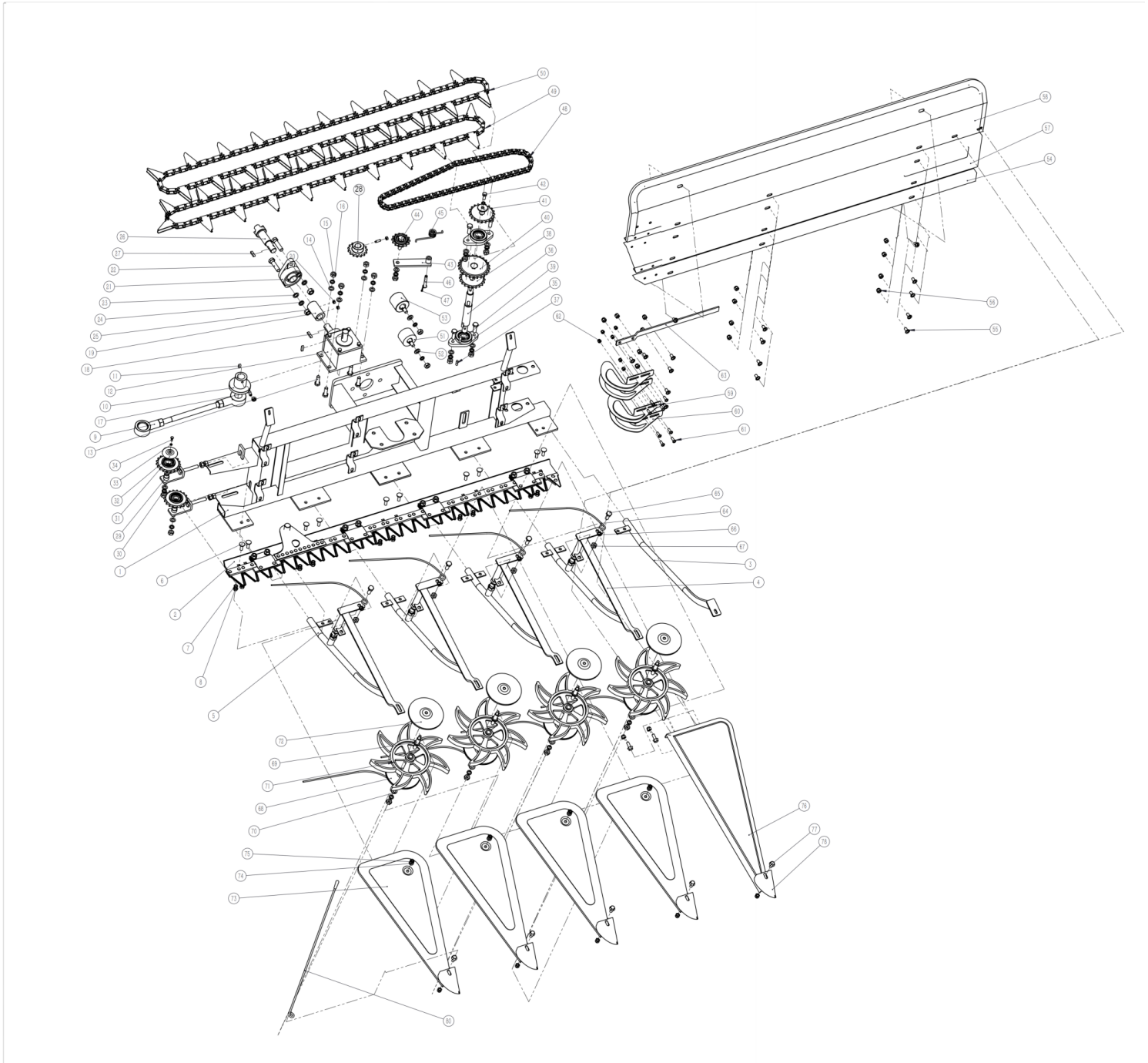

## RIPPER

No.	Product code	Description	Quantity	Specification
1	DUPYX7SGJ-010000	Main Chassis	1	
2	DUPYX7SGJ-020000	Blade assy	1	
3	DUPYX7SGJ-030000	Grain divider 1	1	
4	DUPYX7SGJ-040000	Grain divider 2	4	
5	DUPYX7SGJ-050000	Grain divider 3	4	
6	DUPGB/T 801-1998	Small semicircle head low square neck bolt	10	
7	DUPGB/T 93-1987	Elastic washer	11	
8	DUPGB/T 6170-2015	Hexagon nut	11	
9	DUPYX7SGJ-060000	Adjust rod Assy	1	
10	DUPYX7SGJ-070000	Connecting shaft	1	
11		Square key	2	6x16x6
12	DUPYX7SGJ-080000	Reducer Assy	1	
13	DUPGB/T 5783-2016	Full thread hexagon fangle bolt M10X30	8	M10X30
14	DUPGB/T 848-2002	Flat washer	11	M10
15	DUPGB/T 93-1987	Elastic washer	7	
16	DUPGB/T 6170-2000	Hexagon nut	17	M10
17	DUPYX7SGJ-090000	Fixing hexagon bolt	1	M8
18		Square key	1	6x26x6
19	DUPYX7SGJ-100000	Soacer of main shaft	1	
20	DUPGB/T 6170-2015	Hexagon nut M6	3	M6
21	DUPGB/T 7810-2017	Bearing with diamond-shaped seat	1	
22	DUPGB/T 5783-2016	Full thread hexagon fangle bolt M12X45	2	M12X45
23	DUPGB/T 848-2002	Flat washer	2	M12
24	DUPGB/T 93-1987	Elastic washer	2	
25	DUPGB/T 6170-2015	Hexagon nut M12	2	M12
26	DUPYX7SGJ-120000	Connecting shaft with 3-teeth claw	1	
27		Square key	2	6x23x6
28	DUPYX7SGJ-130000	Driving sprocket 1	1	
29	DUPYX7SGJ-140000	Sprocket fixing bracket	2	
30	DUPGB/T 93-1987	Elastic washer	6	M10
31	DUPYX7SGJ-150000	Passive sprocket assy	2	
32	DUPYX7SGJ-160000	Camp of sprocket	1	
33	DUPGB/T 93-1987	Elastic washer	1	
34	DUPGB/T 5783-2016	Full thread hexagon fangle bolt M5X12	1	M5X12
35		Bearing with seat	2	6203-2RS
36	DUPYX7SGJ-170000	Sprocket shaft	1	
37		Square key	1	6x19x6
38	DUPYX7SGJ-180000	Driving sprocket 2	2	
39		Square key	1	8x25x7
40	DUPYX7SGJ-190000	Driven sprocket	1	
41		Flat washer	1	M8.5x34x3
42	DUPGB/T 5783-2016	Full thread hexagon fangle bolt M8X20	1	M8X20
43	DUPYX7SGJ-200000	Tensioner bracket	1	
44	DUPYX7SGJ-210000	Tension pulley	1	

45	DUPYX7SGJ-220000	Pressure spring	1	
46	DUPGB/T 882-2008	Pin type B	1	8x50
47	DUPGB/T 91-2000	Split pin	1	3.2x20
48	DUPYX7SGJ-230000	Transimission chain	1	08B-12.7
49	DUPYX7SGJ-240000	Transimission chain with triangle fork 1	1	
50	DUPYX7SGJ-250000	Transimission chain with triangle fork 2	1	
51	DUPYX7SGJ-260000	Directive pulley 2	1	
52	DUPGB/T 97.2-2002	Flat washer	2	
53	DUPYX7SGJ-270000	Directive pulley 1	1	
54	DUPYX7SGJ-280000	Chain limite board 3	1	
55		Semicircle head flange bolt	16	M8
56	DUPGB/T 6182-2016	Non-metal embed hexagon lock nut M8	23	M8
57	DUPYX7SGJ-290000	Chain limite board 2	1	
58	DUPYX7SGJ-300000	Protective board	1	
59	DUPYX7SGJ-310000	Directive board 1	2	
60	DUPYX7SGJ-320000	Directive board 2	2	
61		Semicircle head flange bolt	8	M6
62	DUPGB/T 6182-2016	Non-metal embed hexagon lock nut M6	8	M6
63	DUPYX7SGJ-330000	Fixing plate	1	
64	DUPYX7SGJ-340000	Directive rod	8	
65	DUPGB/T 5783-2016	Full thread hexagon fangle bolt M10X30	4	M10X30
66	DUPGB/T 93-1987	Elastic washer	8	M10
67	DUPGB/T 6170-2000	Hexagon nut M10	8	M10
68	DUPYX7SGJ-350000	Lower lid of impeller	4	
69	DUPYX7SGJ-360000	fixing shaft of impeller	4	
70	DUPGB/T 97.2-2002	Flat washer M10	4	M10
71	DUPYX7SGJ-370000	Impeller	4	
72	DUPYX7SGJ-380000	Top lid of impeller	4	
73	DUPYX7SGJ-390000	Grain divider borad	4	
74	DUPGB/T 848-2002	Flat washer	4	
75	DUPGB/T 6170-2015	Hexagon nut M8	4	M8
76	DUPYX7SGJ-400000	Grain divider borad 3	1	
77	DUPGB/T 5789-1986	Hexagon fangle bolt	7	
78	DUPYX7SGJ-410000	Grain divider borad cap	5	
79	DUPYX7SGJ-110000	Fixing hexagon bolt	1	M6
80	DUPYX7SGJ-420000	Flagpole	1	