

LITTLE BEAVER

Parts diagram



The model may differ slightly from the picture

DUETCS4100-16
Little Beaver Chainsaw - 40cc
16" bar

BASE UNIT

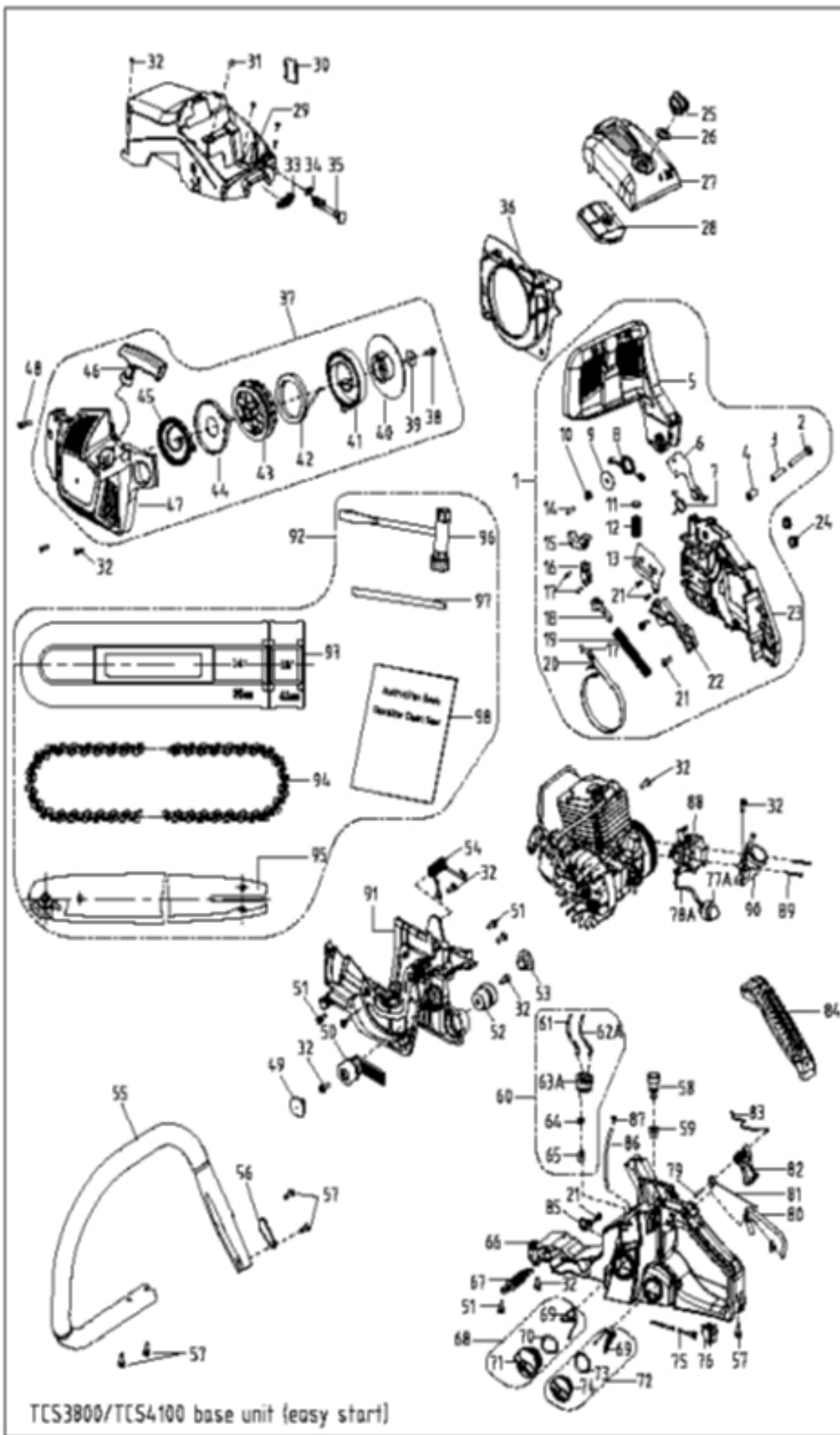

TCS3800/TCS4100 base unit (easy start)

Number	Part number	Part name	Quantity
1	T+B41:B115CS3800.04.00-00	Right cover assembly	1
2	YD38-3.04.00-16	Screw M5×40	1
3	YD38-3.04.00-13	Baffle bushing 5x6.3x30	1
4	YD38-3.04.00-12	Weighted bushing 6.3x9x15	1
5	TCS3800.04.00-2	Front baffle	1
6	YD38-3.04.02-00	Weight	1
7	YD38-3.04.00-7	Heavy duty torsion spring	1
8	YD38-3.04.00-9	Brake torsion rod spring	1
9	YD38-3.04.00-14	Washer 5.2×23×1.2	1
10	GB/T6185.1	Self-locking nut M5	1
11	YD38-3.04.00-6	Spring base	1
12	YD38-3.04.00-5	Front fender compression spring	1
13	YD38-3.04.00-15	Tensioner cover plate	1
14	GB/T119.2	Pin 3×14	1
15	YD38-3.04.00-4	Main level	1
16	YD38-3.04.00-3	Secondary tie rod	1
17	GB/T119.2	Pin 3×9	3
18	YD38-3.04.00-11	Brake control lever	1
19	YD38-3.04.00-8	Brake spring	1
20	YD38-3.04.00-10	Brake belt	1
21	GB/T845-20051790	Self-tapping screw ST4.2×9.5	5
22	YD38-3.04.00-1	Brake spring cover plate	1
23	TCS3800.04.01-00	Right cover	1
24	GB/T6177.1	Hexagonal flange nut M8	2
25	TCS3800.05.01-00	Air filter lock nut	1
26	YD38-3.05.00-6	Lock nut washer 15×26×1	1
27	TCS3800.05.00-2	Air filter cover	1
28	YD38-5.01.08.00-00	Air filter	1
29	TCS3800.05.00-1	Upper cover plate	1
30	YD38-3.05.00-5	Anti-freeze block	1
31	YD38-3.05.00-4	Vibration damping block	1
32	GB/T845-20051824	Self-tapping screw ST4.8×16	12
33	YD38-3.00.00-7	Dust shield	1
34	YD38-3.00.00-11	Throttle lever retaining bracket	1
35	YD38-5.00.00-10	Throttlet rod	1
36	TCS3800.02.00-1	Deflector	1
37	TCS3800.02.00-00	Starter assembly	1
38	GB/T845	Self-tapping screw ST4.8×13	1
39	GB/T96	Washer 5	1
40	YD38-5.12.00-6	Starter ratchet	1
41	YD38-5.12.00-5	Strip spring	1
42	YD38-3.02.00-6	Starter pull rope 3×920	1
43	YD38-7.02.00-4	Starter plate	1

Number	Part number	Part name	Quantity
44	YD36.02.01-2	36 coil spring gland	1
45	YD36.02.01-4	36 starter coil spring	1
46	YD38-5.02.00-4	Starter handle	1
47	TCS3800.02.01-00	Starter cover	1
48	GB/T845	Self-tapping screw ST4.8×19	1
49	GB/T845	Self-tapping screw ST4.8×25	5
50	YD38-3.00.00-9	Left dust cover	1
51	YD38-3.06.04-00	Long shock absorbing seat 1	1
52	GB/T818	Screw M5×14	5
53	YD38-3.06.03-00	Shock absorbing seat 2	1
54	YD38-3.00.00-8	Right dust cover	1
55	YD38-3.00.00-4	Front handle torsion spring	1
56	YD38-3.00.00-1	Front handle	1
57	YD38-3.00.00-13	Torsion rod spring cover plate	1
58	YD38-3.03.06-00	Balancer body assembly	1
59	YD38-3.03.00-3	Balancer holder	1
60	YD38-3.03.05-00	Fuel filter assembly w/tube	1
61	YD38-3.03.00-1	Fuel tube	1
62	YD38-3.03.00-1A	Oil return pipe	1
63	YD38-3.03.00-2A	Fuel tube holder	1
64	YD38-3.03.00-12	Counterweight block	1
65	YD38-3.03.04-00	Fuel filter assembly	1
66	YD38-6.03.01-00	Base	1
67	YD38-3.00.00-5	Base tension spring	1
68	TCS4600.03.02-00	Fuel port cover assembly	1
69	YD38-3.03.03-2	Anti-drop plate	2
70	JB/T7757.2	O-ring rubber seal 24.7×3.55	1
71	TCS4600.03.02-1	Fuel port cover	1
72	TCS4600.03.03-00	Oil port cover assembly	1
73	JB/T7757.2	O-ring rubber seal 20×3.1	1
74	TCS4600.03.03-1	Oil port cover	1
75	YD38-3.01.11.03-00	Grounding wire	1
76	YD38-3.01.11.04-00	Extinction switch	1
77	YD38-3.03.00-4A	Primer pump	1
78	YD45-4.03.00-13	Pump tube	1
79	GB/T119.2	Pin 5×24	1
80	YD38-3.03.00-9	Trigger control arm	1
81	YD38-3.03.00-8	Trigger torsion rod spring	1
82	YD38-3.03.00-7	Trigger	1
83	YD38-5.00.00-6	Throttle push rod	1
84	TCS3800.03.00-10	Handle cover	1
85	YD38-3.03.00-16	Circlip for nozzle	1

Number	Part number	Part name	Quantity
86	YD38-3.00.00-2	Ventilation tube 3.5×6.5×72	1
87	GB/T845	self-tapping screw ST4.2×14	1
88	YD38-3.01.06.00-00	Carburetor	1
89	YD38-3.01.00-17	Carburetor screw	2
90	YD38-3.01.00.02-00	Air intake seat	1
91	YD38-5.06.01-00	Case	1
92	YD38-3.08.00-00	Accessory assembly	1
93	YD38-3.07.00-00	Chain cover	1
94	YD38-3.07.02-01	Saw chain	1
95	YD38-3.07.01-01	Guide plate assembly	1
96	YD38-3.08.01-00	Sleeve plate handle	1
97	YD38-3.08.04-00	File	1
98	YD38-3.08.03-00	Instruction manual	1